

A:A

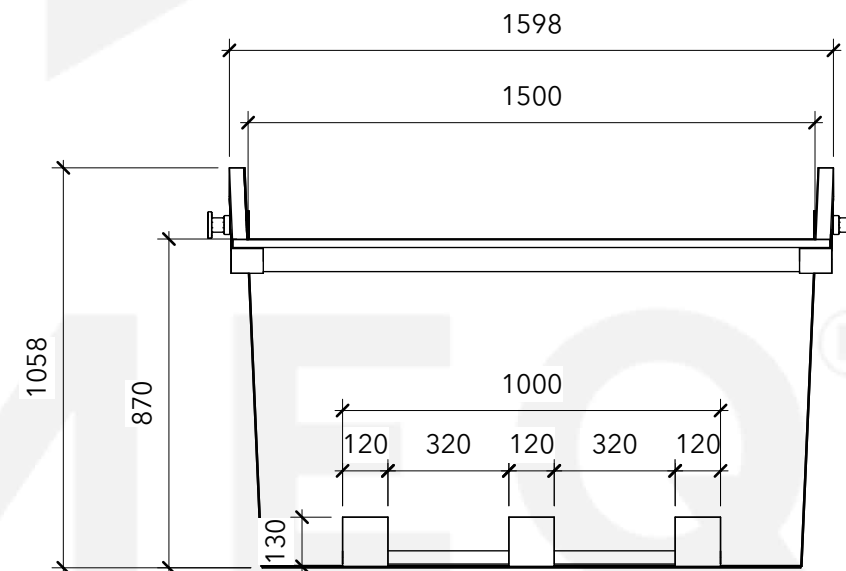
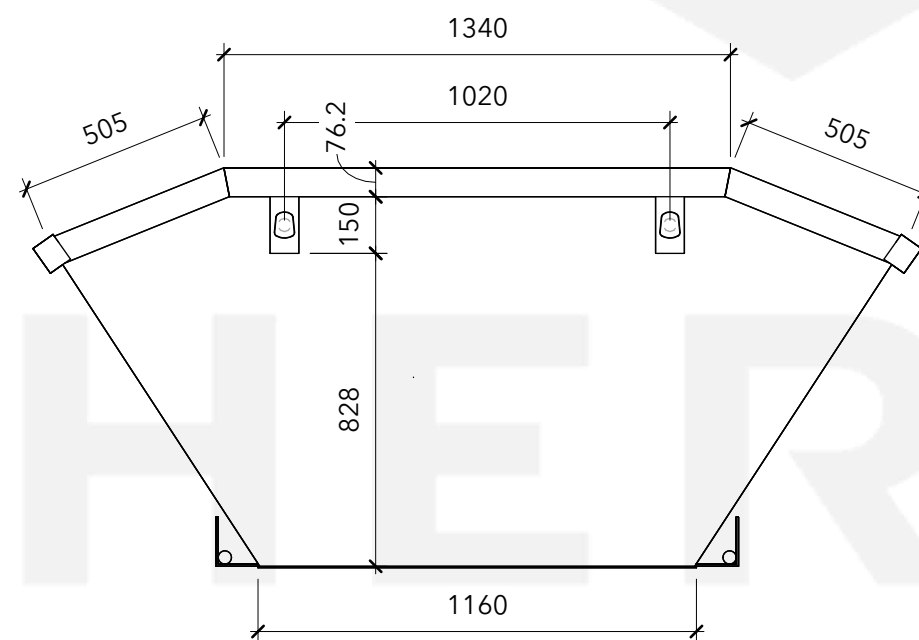

General Comments

Materials

Mild Steel



Email: sales@hermeq.com

No.	Description	Date
A	Updated and Detailed Lifting Lugs	09/10/24

SKU	Component Description	Quantity
CPBAR00018	BAR-H-35-1000	2
CPBEN00071	BEN-H-Builders Skip - Bar Support - Ends - G6mm - 120mm x 130mm x 120mm - (Bent)	6
CPBEN00072	BEN-H-Builders Skip - 6 Yard - Reinforcement - G3mm - 150mm x 80mm - Bent	4
CPBLA00069	BLA-H-1425-1160-4 - Builders Skip - Base - 4 Yard (Double)	1
CPMAN00191	Mild Steel Channel - 76mm x 38mm x 150mm - 6.7KG - Drilled	4
CPPRO00120	PRO-H-Builders Skip - Side - 4 Yard (Double) - HR Profile Shape - 2281mm x 1055mm - 3mm	2
CPPRO00121	PRO-H-Builders Skip - Upslope - 4 Yard (Double) - HR Profile Shape - 1500mm x 1030mm - 3mm	2
CPPRO00134	PRO-H-Builders Skip - Lifting Lug Fixing Plate - HR Profile Shape - 75mm - 4mm	4
CPPUR00079	PUR-Mild Steel Channel - 76mm x 38mm x 1580mm - 6.7KG	2
CPPUR00080	PUR-Mild Steel Channel - 76mm x 38mm x 505mm - 6.7KG	4

Builders Skip - 4 Yard -Open Double Tipping Skip - Unpainted

Weight	N/A	Serial Number	Revision
Date	13/09/2024	CPMAN00116	A
Drawn by	JT		
Approved by	GM	Scale	As indicated @A3

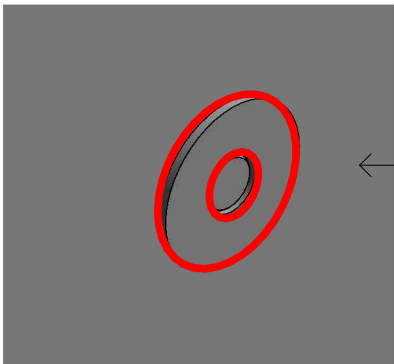

FULLY WELDED INSIDE
AND OUTSIDE TO FIXING
PLATE

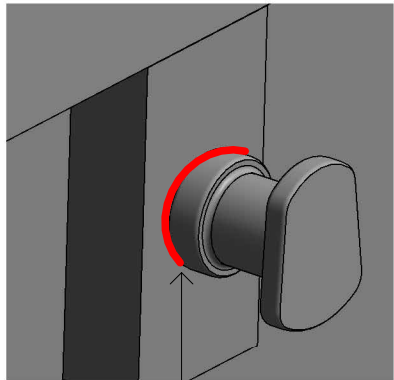

FULLY WELDED TO
OUTSIDE OF CHANNEL

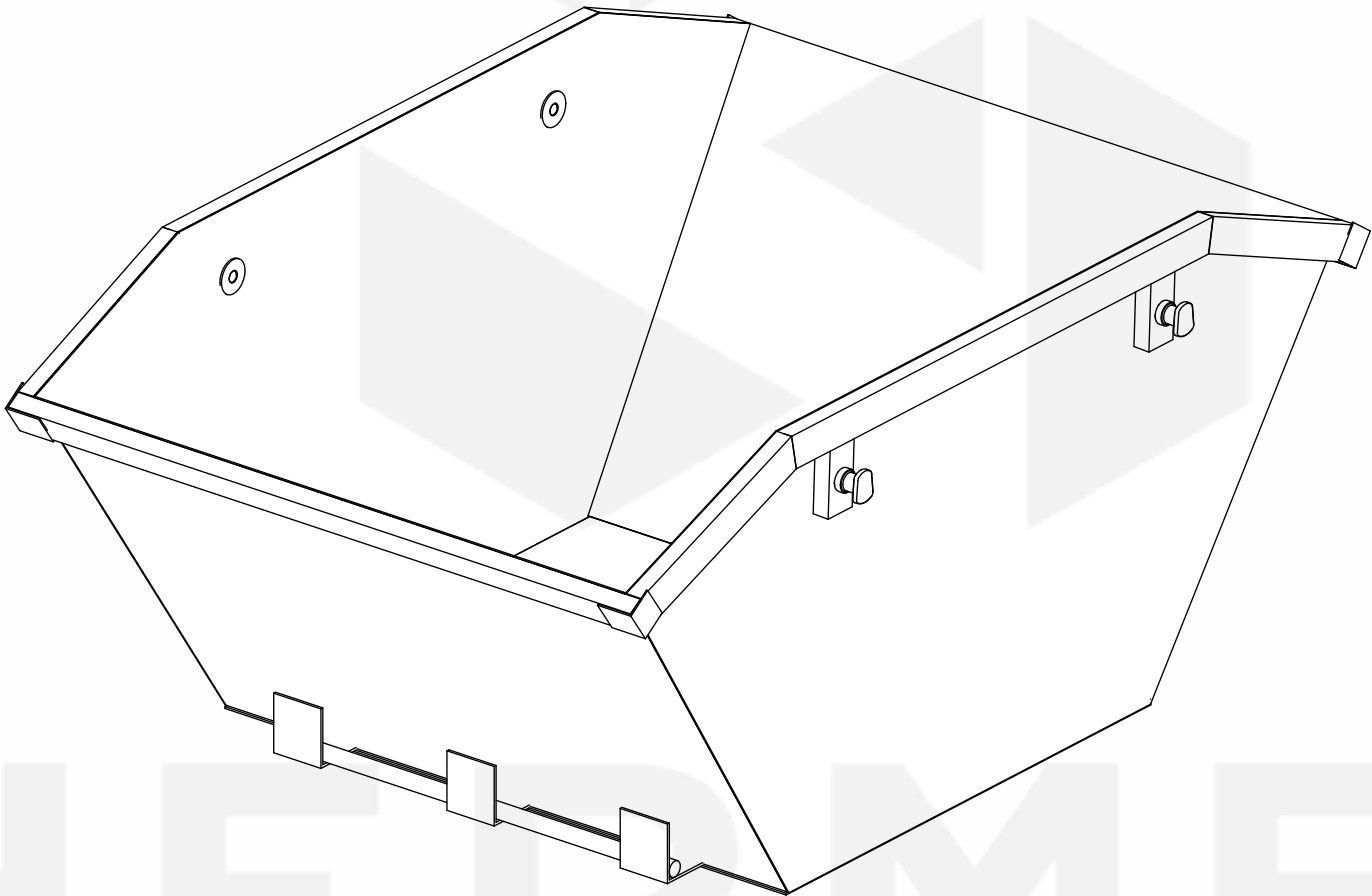

General Comments

Materials

Mild Steel



Email: sales@hermeq.com

No.	Description	Date
A	Updated and Detailed Lifting Lugs	09/10/24

SKU	Component Description	Quantity
CPPUR00081	PUR-Mild Steel Channel - 76mm x 38mm x 1340mm - 6.7KG	2
CPPUR00086	PUR-Skip Lifting Lug - 108mm x 55mm x 70mm	4

Builders Skip - 4 Yard -Open Double
Tipping Skip - Unpainted

Weight	N/A	Serial Number	Revision
Date	13/09/2024	CPMAN00116 - 3D VIEW	A
Drawn by	JT		
Approved by	GM	Scale	@A3